

## Dry Evotek Couplings

### Applications

- Specifically designed for use in the chemical industry
- Rotating the coupling 120° clockwise opens the valves where the pressure engagement between hose and tank unit ensures a strong connection

### Sizes

- 1", 1-1/2", and 2"
- Additional sizes upon request

### Features

- Low connecting forces even against pressure
- Ergonomic handle on 1-1/2" and 2" sizes
- Good transmission ratio in the cam curve
- Wide range of chemical resistance due to high-quality material selection
- Minimized spillage during de-coupling

### Materials

- Body: stainless steel 1.4404
- Handle: PP polypropylene; 1" does not come with a handle
- O-rings: FPM, NBR, EPDM, FFKM
- Standard seal: FKM
- Optional seal: EPDM, NBR, and FFKM

### Specification

- Working pressure: **360 PSI** at ambient temperature 70°F (21°C)

### Approvals

- PED 2014/68/EU 4.3
- ATEX 2014/34/EU Category 3G



### Adapter x Female NPT

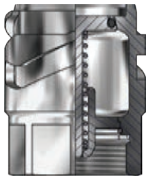

Female NPT	Body Size	Part #
1"	59.5 mm	DDEA100SS
1-1/2"	89 mm	DDEA150SS
2"	106 mm	DDEA200SS

### Adapter x 150# Flange

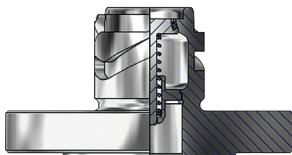

150# Flange	Body Size	Part #
1"	59.5 mm	DDEA100SSFL
1-1/2"	89 mm	DDEA150SSFL
2"	106 mm	DDEA200SSFL

### Coupler x Female NPT

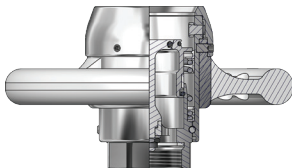

Female NPT	Body Size	Part #
1"	59.5 mm	DDEC100SS
1-1/2"	89 mm	DDEC150SS
2"	106 mm	DDEC200SS

### Coupler x 150# Flange

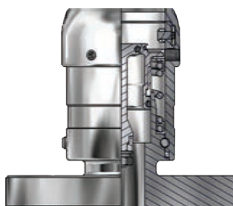

150# Flange	Body Size	Part #
1"	59.5 mm	DDEC100SSFL
1-1/2"	89 mm	DDEC150SSFL
2"	106 mm	DDEC200SSFL