

Maintenance & Operating Instructions

For

Dixon Bayco

Trailer Mounted Individual Sockets

For Sales and Service Contact

USA:

Dixon Bayco USA
Chestertown, Maryland
Phone: 410-778-2000
Fax: 410-778-4702
Toll Free: 800-355-1991
E-mail: dixonbayco@dixonvalve.com

Canada:

Dixon Group Canada Limited
Innisfil (Barrie), Ontario
Phone: 705-436-1125
Fax: 705-436-6251
Toll Free: 877-963-4966
E-mail: isales@dixongroupcanada.com

Europe:

Dixon Group Europe Ltd
Preston, England
Phone: +44 (0)1772 323529
Fax: +44 (0)1772 314664
E-mail: enquiries@dixoneurope.co.uk

Asia Pacific:

Dixon (Asia Pacific) Pty Ltd Wingfield,
South Australia
Phone: +61 8 8202 6000
Fax: +61 8 8202 6099
E-mail: enquiries@dixonvalve.com.au

Mexico:

Dixva, S. de R.L. de C.V.
Monterrey, N.L.
Phone: 01-800-00-DIXON (34966)
Fax: 01-81-8354-8197
E-mail: contactenos@dixonvalve.com.mx



The Right Connection®

dixonvalve.com

Installation

Sockets are to be mounted on the same side of the trailer as the bottom loading equipment. Sockets are normally located within 3 feet of the bottom loading adapters so the rack plug and cord will reach the socket without over stretching the cord. Remove the socket faceplate and hardware packet and set aside. Use the socket body as a template to drill two 11/32" holes as shown in Diagram 1. Mount the socket body to the trailer using two 5/16" bolt and lock washers. Make sure the grounding wire, large eyelet end is fastened under one of the 5/16" bolts.

DIAGRAM 1

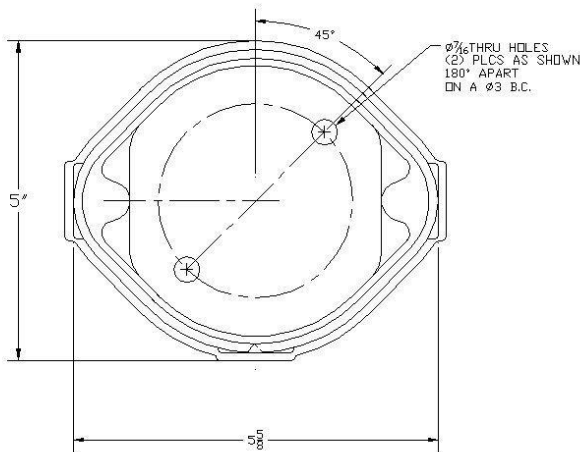

Wiring Instructions

When wiring the sockets to an onboard monitor it is highly recommended using FloTech FT401 jacketed 5-conductor cable when wiring a new system. FloTech cable is designed to be oil, UV, and abrasion resistant. We incorporate a noble tin plated stranded copper wire which resists corrosion. These features will provide years of reliable service.

1. After all sensors are mounted in each compartment, align the conduit openings so they face the roll over rail.
2. Thread in cable glands and pull a length of cable through the conduit openings between each sensor.
3. Cut to length leaving approximately 8" extra length exiting the top of each probe holder.
4. All socket cables must enter or leave through one of the ½" NPT openings. Use FloTech FT402 ½" NPT cable glands to ensure a water tight seal. Unused conduit openings must have a ½ NPT pipe plug installed. Use pipe dope on all ½" NPT threads to ensure a water tight seal.
5. Wire the sockets according to diagram 2 below. Double check your wiring connection when complete. It is highly recommended to use a small amount of Silicone RTV sealant in each crimp connection. Fill the FloTech butt end crimps with Silicone RTV sealant prior to inserting the wires then crimp. This will provide a watertight and vibration resistant connection.

When wiring is complete, replace each sensor cap and O-ring.



Do not pinch a sensor wire when installing the cap.

DIAGRAM 2

FLOTECH OPTIC SOCKETS

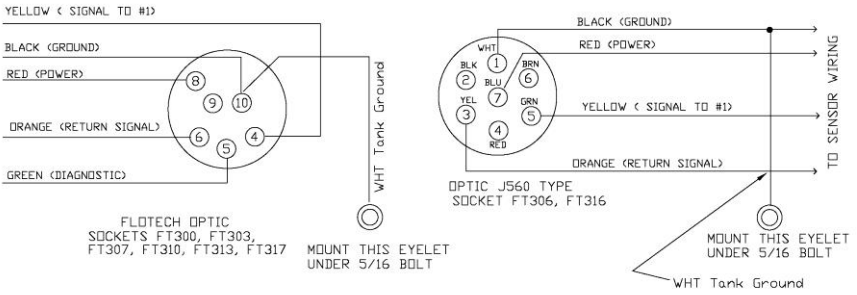

VIEWED FROM WIRE CONNECTION SIDE

DIAGRAM 2 (CONTINUED)

FLOTECH THERMISTOR SOCKETS

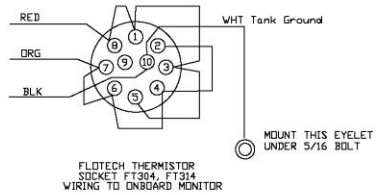
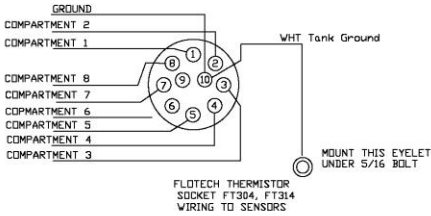

VIEWED FROM WIRE CONNECTION SIDE

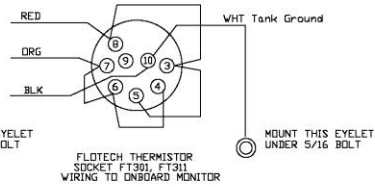
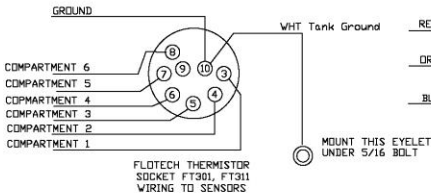

VIEWED FROM WIRE CONNECTION SIDE

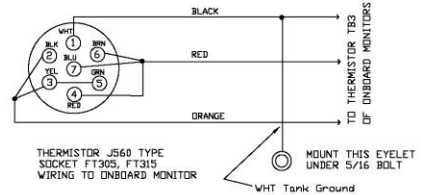
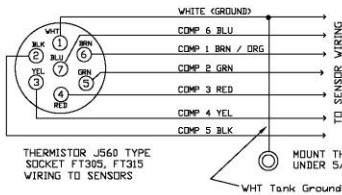

FLOTECH FLOAT SOCKET

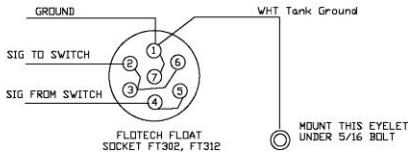

VIEWED FROM WIRE CONNECTION SIDE

Dixon Bayco Warranty

For complete warranty information, please refer to the latest
Dixon catalog.